

A close-up, high-angle photograph of a car wiper blade on a windshield. The blade is dark and sleek, with a visible joint and a small rectangular cutout. The background is a dark, slightly blurred windshield. In the bottom left corner, there is a small graphic of water splashing over a checkered pattern.

# **Instruction for Installing/Replacing Car Wiper Blades**



## **Instruction for Installing/Replacing Car Wiper Blades**

We recommend replacing wiper blades with new ones at least every 12 months. For higher annual/monthly mileage or noticeable deterioration in windshield cleaning quality, it is advisable to increase the frequency of wiper replacement. Ensure the wipers and their arms are in proper condition. Regular inspection of wiper components will ensure safe and trouble-free use.

### **Safety Instructions**

- Carefully familiarize yourself with the product before use.
- Check if the product is complete and includes all necessary components.
- Read the installation manual and follow it step by step.
- Review the safe usage guidelines.

### **Choose Your Mounting Type and Follow the Installation Instructions:**

1. Park your car in a safe location before starting the wiper replacement process.
2. Ensure that the car and its ignition are turned off.
3. If your car model allows it, set the wipers to the service/replacement mode. Refer to your car's user manual for guidance.
4. Protect the windshield with a soft material to prevent accidental damage during wiper replacement.
5. Remove the old wipers by reversing the installation process—refer to the wiper installation instructions.
6. Install the new wipers according to the provided installation instructions.
7. Remove the plastic protective cover from the wiper blade.
8. Verify that the installation has been completed correctly.

## AQUATEC Wiper Installation Guide

**SV-A**



1 Attach the Wiper Blade to the Arm



2 Rotate Until the Blade Is in the Correct Position

**SV-B**

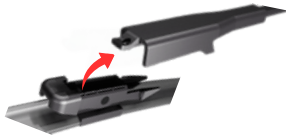

Attach the wiper blade to the arm and snap it into place.

**SV-C**

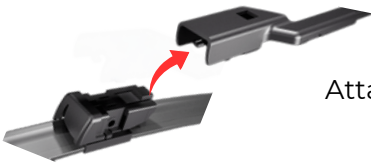

Attach the wiper blade to the arm and snap it into place.

**SV-D**



Attach the wiper blade to the arm and snap it into place.

**SV-E**

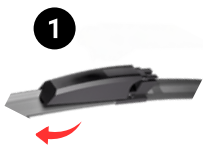

1 Slide the wiper mount open.



2 Attach the wiper blade to the arm.

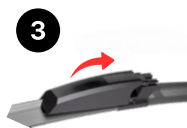

3 Slide the wiper mount closed.

**SV-F**

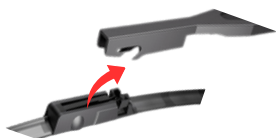

Attach the wiper blade to the arm and snap it into place.

**SV-G**

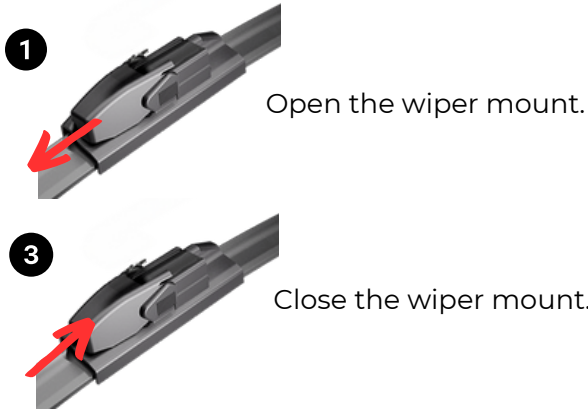

**SV-H**

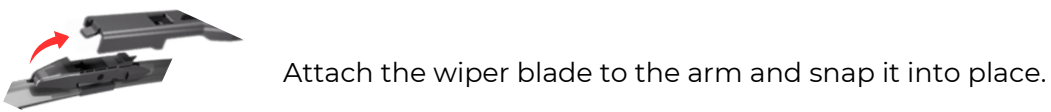

**SV-I**

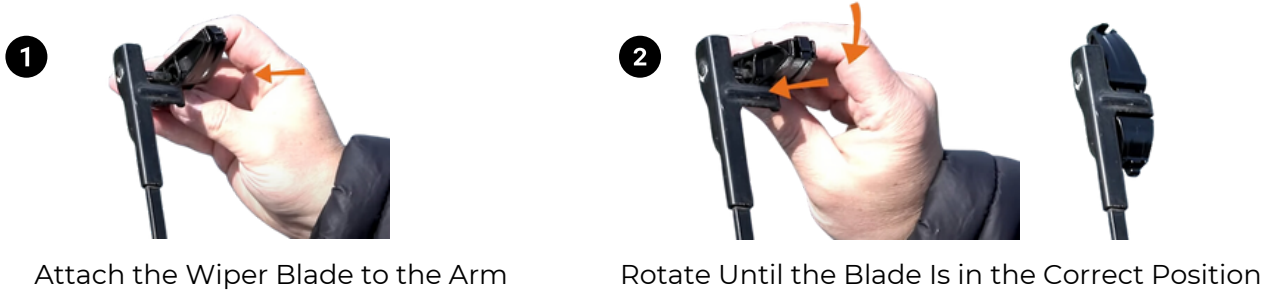

**SV-J**

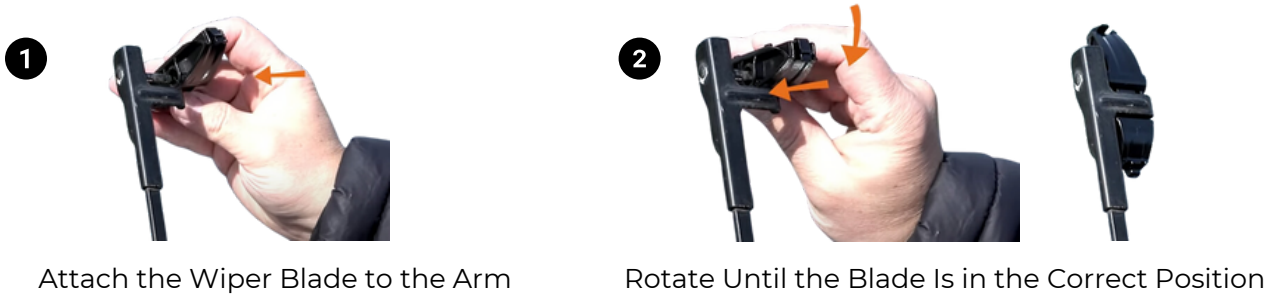

**SV-K**

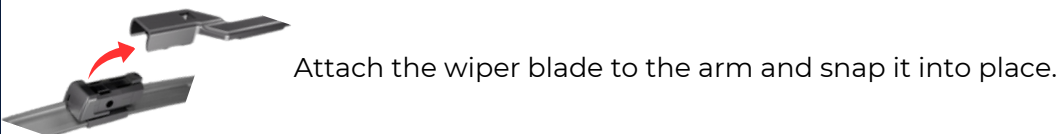

**SV-L**



**SV-M**

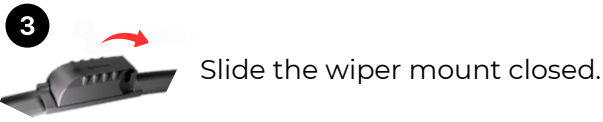
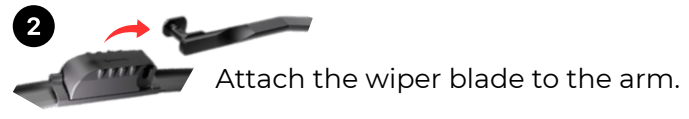
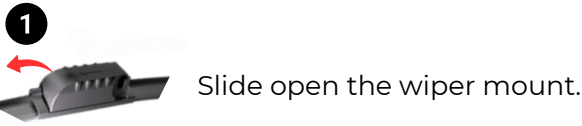

**SV-N**



Attach the Wiper Blade to the Arm



Rotate Until the Blade Is in the Correct Position

**SV-P**

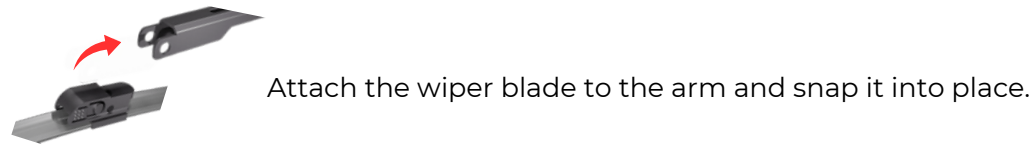

**SV-R**

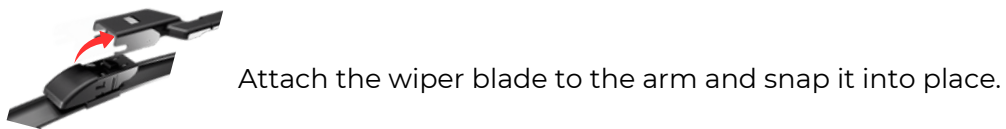

**SV-S**

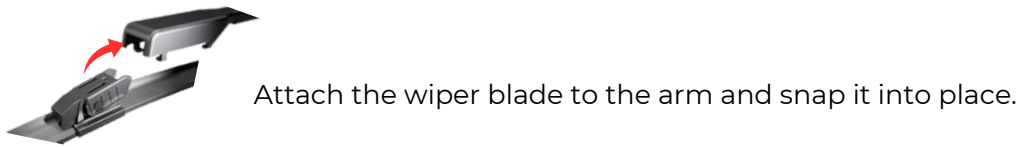

**SV-T**

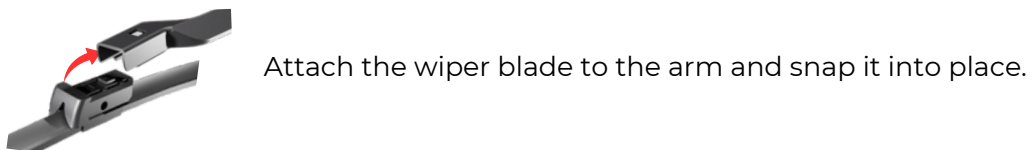



**SV-U**



Open the wiper mount.



Place the car wiper arm in the mount and slide it back until it snaps into the correct position.



Close the wiper mount.

**SV-W**

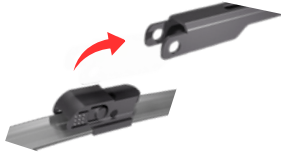

Attach the wiper blade to the arm and snap it into place.

## HEXA Wiper Installation Guide

**H002**



1 Attach the Wiper Blade to the Arm



2 Rotate Until the Blade Is in the Correct Position

**H003**

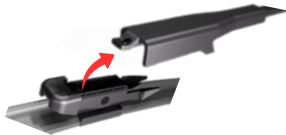

Attach the wiper blade to the arm and snap it into place.

**H004**

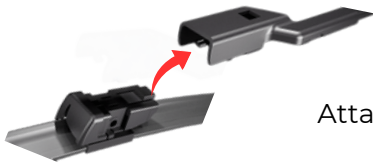

Attach the wiper blade to the arm and snap it into place.

**H005**



Attach the wiper blade to the arm and snap it into place.

**H006**

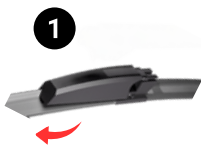

1 Slide the wiper mount open.

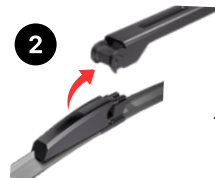

2 Attach the wiper blade to the arm.



3 Slide the wiper mount closed.

**H007**



Attach the wiper blade to the arm and snap it into place.

**H008**

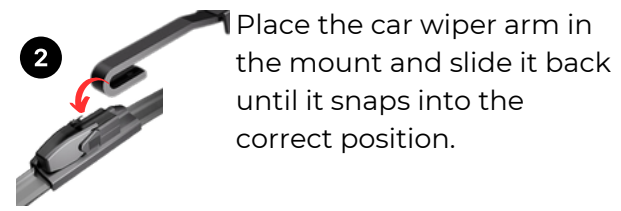
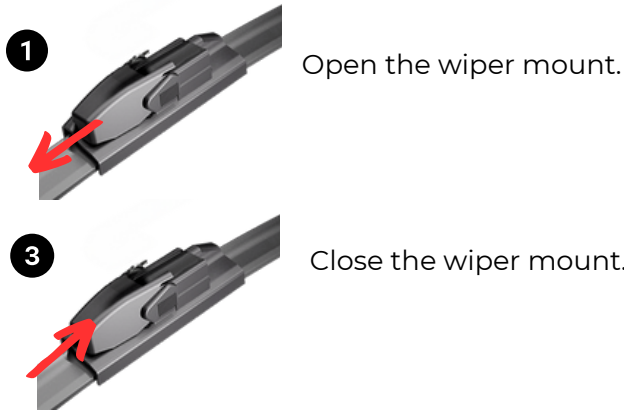

**H009**

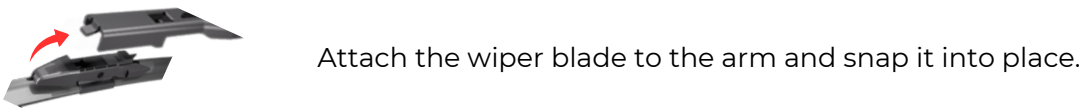

**H010**



**H011**



**H012**

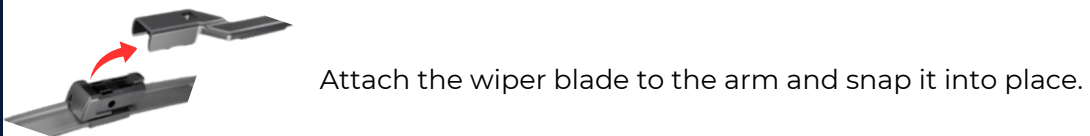

**H013**





**H014**

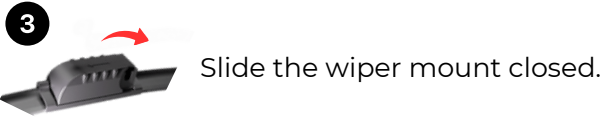
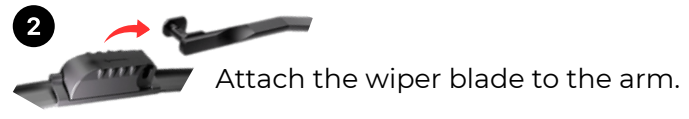
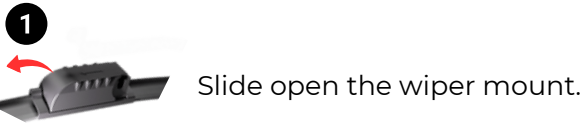

**H015**



Attach the Wiper Blade to the Arm



Rotate Until the Blade Is in the Correct Position

**H016**

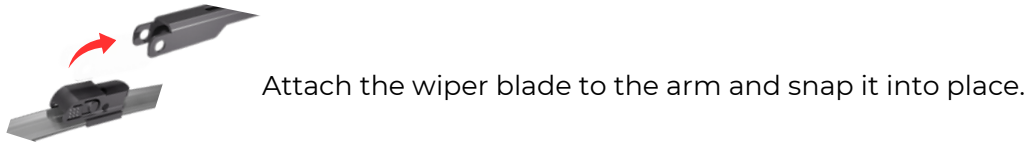

**H017**

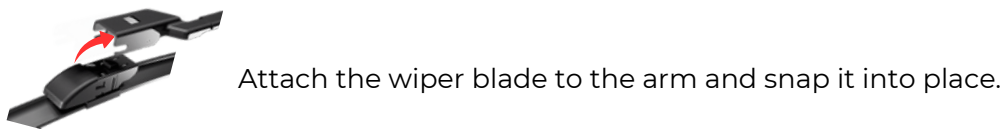

**H018**

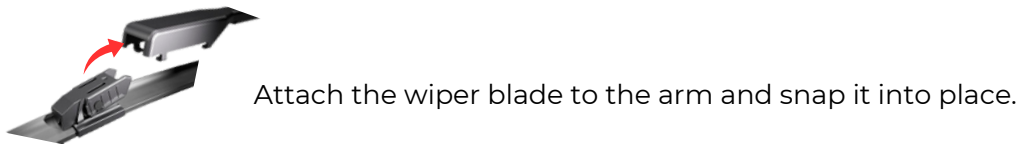

**H019**

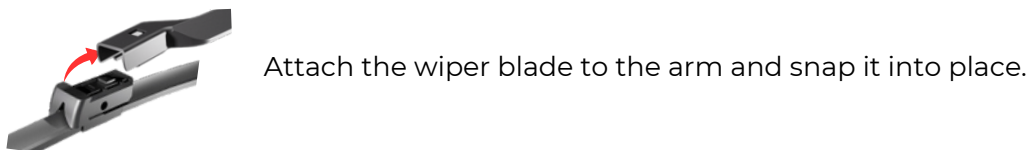

**H001**



Open the wiper mount.



Place the car wiper arm in the mount and slide it back until it snaps into the correct position.



Close the wiper mount.

**H020**

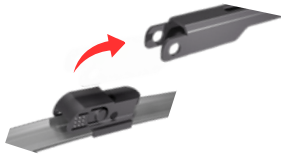

Attach the wiper blade to the arm and snap it into place.

## STANDARD Wiper Installation Guide



Open the wiper mount.



Place the car wiper arm in the mount and slide it back until it clicks into the correct position.



Close the wiper mount.

## ECONO Wiper Installation Guide



Place the windshield wiper arm onto the mounting bracket.



Slide the wiper backward until it locks into the correct position.

## SYNERGY+ Wiper Installation Guide



Open the wiper assembly.



Place the windshield wiper arm into the mounting bracket and slide it backward until it locks into the correct position.



Close the wiper assembly.

SV-U

SV-U

SV-U

## BACK SIDE Wiper Installation Guide

(wipers marked with: RV-9, RV-11, RV-13, RV-21, RV-23, RV-24, RV-28, RV-39, RV-D, RV-F, RV-G, RV-H, RV-I, RV-J, RV-K, RV-L, RV-M, RV-N, RV-Q, RV-X, RV-34)



Place the windshield wiper arm onto the mounting bracket and rotate until it clicks into the correct position.

(wipers marked with: RV-1, RV-3, RV-5, RV-7, RV-26, RV-30, RV-36, RV-40, RV-43, RV-49, RV-P, RV-R, RV-S, RV-W, RV-V, RV-Z)



Slide the wiper blade into the mounting bracket and snap it into place until you hear a distinct click.

(wipers marked with: RV-2, RV-4, RV-6, RV-16, RV-19, RV-20, RV-27, RV-32, RV-45, RV-T, RV-U)



Place the wiper blade into the mounting bracket and snap it into place until you hear a distinct click (inserting it from below the wiper arm).

The user manual for **VISEE MultiSet** wipers with **Smart Click** mounting.

For installation, you will need:



+



Wipers

Adapters

**AVAILABLE ADAPTERS:**





# MultiSet Wiper Installation Guide

**SV-A**



1 Place the wiper blade onto the adapter.



2 Rotate until the adapter is positioned correctly.



3 Attach the adapter to the wiper arm.

**SV-B**

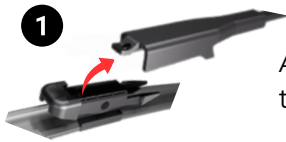

1 Attach the wiper adapter to the arm and snap it into place.



2 Place the wiper blade onto the adapter.

**SV-C**

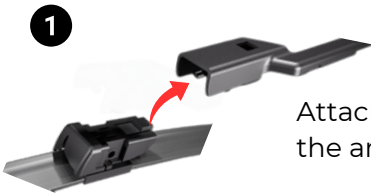

1 Attach the wiper adapter to the arm and snap it into place.



2 Place the wiper blade onto the adapter.

**SV-D**

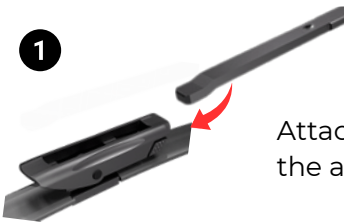

1 Attach the wiper adapter to the arm and snap it into place.



2 Place the wiper blade onto the adapter.

**SV-E**

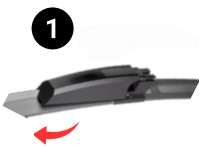

1 Extend the wiper adapter.

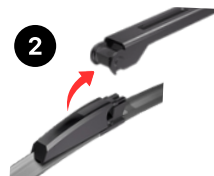

2 Attach the wiper adapter to the arm.



3 Slide the adapter into place.



4 Place the wiper blade onto the adapter.

**SV-F**

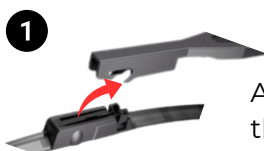

1 Attach the wiper adapter to the arm and snap it into place.



2 Place the wiper blade onto the adapter.

**SV-G**

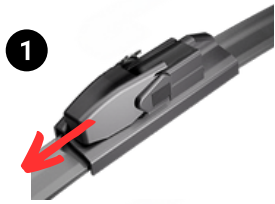

1 Open the wiper assembly.

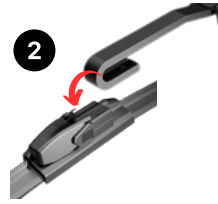

2 Place the windshield wiper arm into the mounting bracket and slide it backward until it clicks into the correct position.

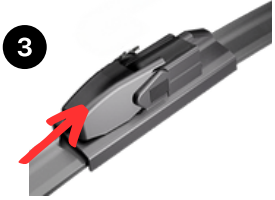

3 Close the wiper assembly.



4 Place the wiper blade onto the adapter.

**SV-H**

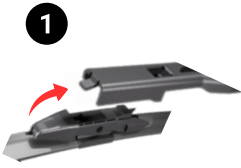

1 Attach the wiper adapter to the arm and snap it into place.



2 Place the wiper blade onto the adapter.

**SV-I**



1 Place the wiper blade onto the adapter.



2 Rotate until the adapter is positioned correctly.



3 Attach the adapter to the wiper arm.

**SV-J**



1 Place the wiper blade onto the adapter.



2 Rotate until the adapter is positioned correctly.



3 Attach the adapter to the wiper arm.

**SV-K**

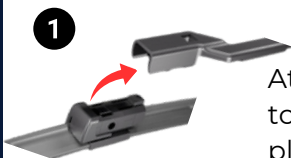

1 Attach the wiper adapter to the arm and snap it into place.



2 Place the wiper blade onto the adapter.

**SV-L**



1 Place the wiper blade onto the adapter.



2 Rotate until the adapter is positioned correctly.



3 Attach the adapter to the wiper arm.

**SV-M**

- 1  Extend the wiper adapter.
- 2  Place the wiper blade onto the arm.
- 3  Slide the adapter into place.
- 4  Place the wiper blade onto the adapter.

**SV-N**

- 1  Place the wiper blade onto the adapter.
- 2  Rotate until the adapter is positioned correctly.
- 3  Attach the adapter to the wiper arm.

**SV-P**

- 1  Attach the wiper adapter to the arm and snap it into place.
- 2  Place the wiper blade onto the adapter.

**SV-R**

- 1  Attach the wiper adapter to the arm and snap it into place.
- 2  Place the wiper blade onto the adapter.

**SV-S**

- 1  Attach the wiper adapter to the arm and snap it into place.
- 2  Place the wiper blade onto the adapter.

**SV-T**

- 1  Attach the wiper adapter to the arm and snap it into place.
- 2  Place the wiper blade onto the adapter.

**SV-U**



Open the wiper assembly.



Place the windshield wiper arm into the mounting bracket and slide it backward until it clicks into the correct position.



Close the wiper assembly.



Place the wiper blade onto the adapter.

**SV-W**

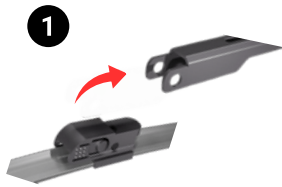

Attach the wiper adapter to the arm and snap it into place.



Place the wiper blade onto the adapter.